

PYRO^{Evo} FOR THE URBAN ENVIRONMENT

The PYRO^{Evo} is an ideal people counting solution for the urban environment. The system combines a high-precision lens with passive infrared pyroelectric technology to detect heat emitted by the human body. Connected, robust and easy to install, the PYRO^{Evo} provides you the key data you need to develop your bike and pedestrian count program. The PYRO^{Evo} is available in two housing options, both specifically designed to blend into and withstand the urban environment.

- + Robust, waterproof and discreet
- + No power supply required
- + Automatic data transmission
- + Remote updates and IoT connectivity



Internal Sensor Without Housing: Physical Characteristics

Waterproofness	IP 68
Temperature Resistance	-25°C to +70°C (-13°F to 158°F)
Storage Temperature	-40°C to +85°C (-40°F to 185°F)
Weight	≈ 400g (0.9 lbs)
Dimensions	10.3 x 10 x 3.8cm (4.05" x 4" x 1.50")
Material	POM-C (Acetal Copolymer)
Color	Black

General Characteristics

Installation	+ PYRO-Box ^{Evo} : installation on flat surface or on a pole + PYRO ^{Evo} in an Urban Post installation with anchors or mechanical pegs
Data Backup	60-minute or 15-minute data recording intervals
Memory	40,000 data points*
Direction	Direction detection optional
Covered Width	Up to 1 meter, 4 meters or 10 meters (3', 15' or 33'). Two sensors can be combined to cover very wide paths
Calibration	Autocalibration
Data Transmission	Automatic data transmission
Battery Life	Up to 2 years**
Power Supply	2 x 3.6V (3.6Ah) lithium batteries (Easily replaceable on the field)
Certification	CE, FCC

*Or 400 days in 15-minute data recording intervals

**For one sensor without direction detection, with an average of 2,400 passages and four data transmissions per day

Connectivity

Wireless Connectivity	+ Bluetooth Low Energy (BLE) 5.0 + LTE Cat-M1/NB1
Communication Protocols	HTTP, HTTPS***
Localization	GNSS

***Available in a future version



PYRO^{EVO} FOR URBAN ENVIRONMENT

Two discreet, durable housing options for the PYRO^{Evo}:

PYRO-Box^{Evo}



Temporary
or permanent
installation

PYRO-Box^{Evo}

- + Material: POM-C (Acetal Copolymer)
- + Color: Grey - RAL 7016 (Custom colors upon request)
- + Weight: ≈ 820g (1.8 lbs)
- + Dimensions: 12.6 x 12.6 x 5.35cm (5" x 5" x 2.10")

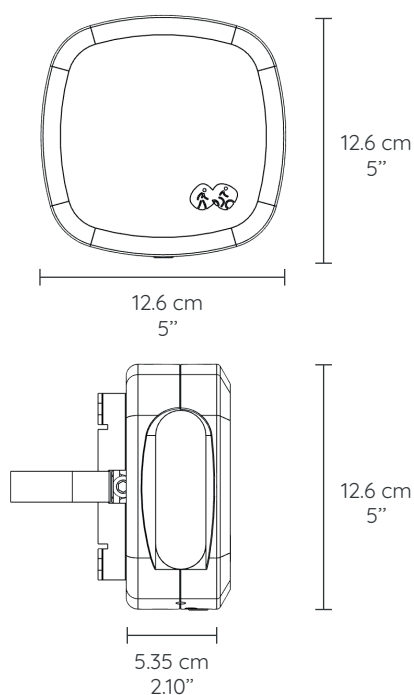

PYRO^{Evo} in an Urban Post



Permanent
installation

PYRO^{Evo} in an Urban Post

- + Material: Aluminium and PVC
- + Color: Grey - RAL 7016 (Custom colors upon request)
- + Dimensions: h = 110cm (43"), internal Ø = 11.5cm (4.50"), external Ø = 12.5cm (5.00")

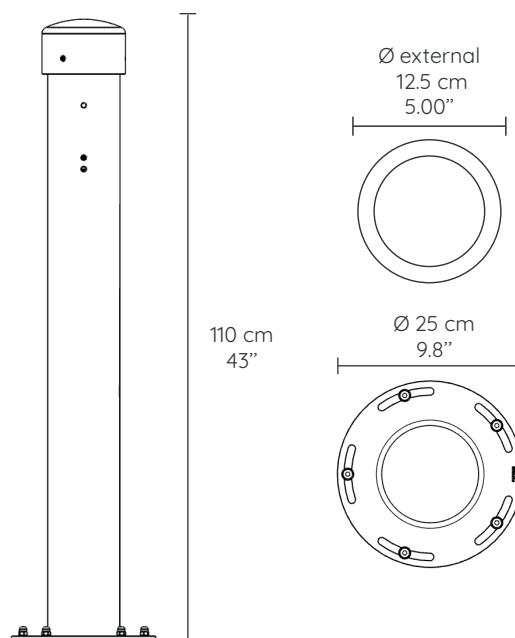

Finn-Raj Oy
Särkijärventie 35, 78880 Kuvansi
+358 400 335 033



www.finnraj.fi | reijo.onikki@finnraj.fi